

	32. Department of Public Works, Roads, and Transport Balmoral Roads Camp Site Balmoral 1037
--	---

PROCLAMATION • PROKLAMASIE

PROCLAMATION 23 OF 2017

EMALAHLENI LOCAL MUNICIPALITY
NOTICE OF APPROVAL OF AMENDMENT SCHEME 2023

The Local Municipality of Emalahleni declares hereby in terms of the provisions of Section 57(1)(a) of the Town-Planning and Townships Ordinance, 1986, that it has approved an amendment scheme, being an amendment of the Emalahleni Land Use Management Scheme, 2010, by the rezoning of Portions 2, 6, 7, 11, 12, the Remaining Extent of Portion 5 and the Remaining Extent of the farm Klippan 332 JS, the Remaining Extent of Portion 2 and the Remaining Extent of the farm Groenfontein 331 JS, the Remaining Extent of Portions 1 and 145 and Portion 167 of the farm Klipfontein 322 JS from "Agricultural" to "Special" with an annexure, Annexure 781 for Industrial purposes to accommodate a Power Station and Ash Residue Disposal Facility.

Map 3 and the scheme clauses of the amendment scheme are filed with the Director, Department of Agriculture, Rural Development and Land Administration Mpumalanga Province, and the Municipal Manager, Emalahleni Local Municipality and are open for inspection at all reasonable times. This amendment is known as Emalahleni Amendment Scheme 2023 and shall come into operation on date of publication of this notice.

T JANSEN VAN VUUREN
MUNICIPAL MANAGER

Civic Centre

Mandela Street

eMALAHLENI

1035

P.O. Box 3

eMalahleni

1035

Notice Number : 50/2017

Publication date : Provincial Gazette of Mpumalanga: 8 September 2017

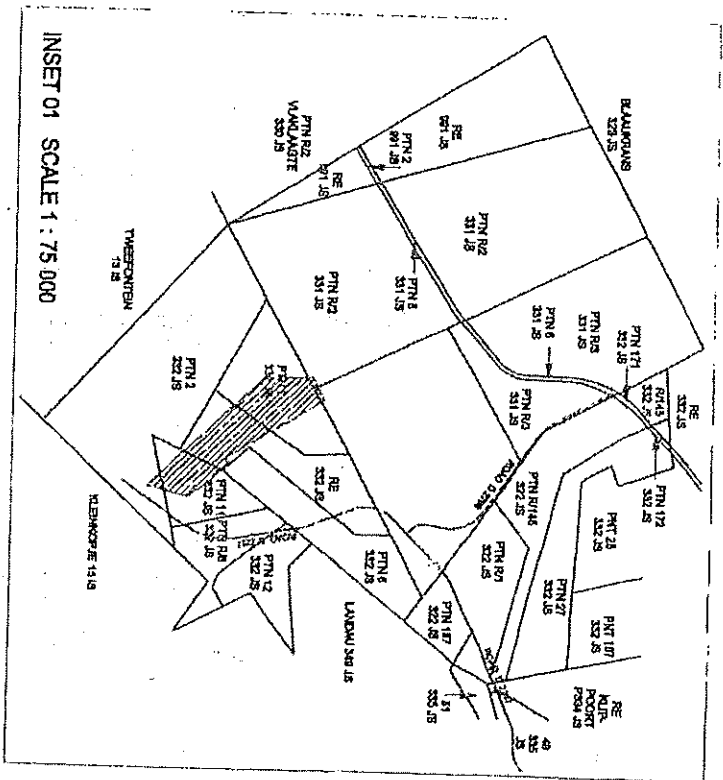
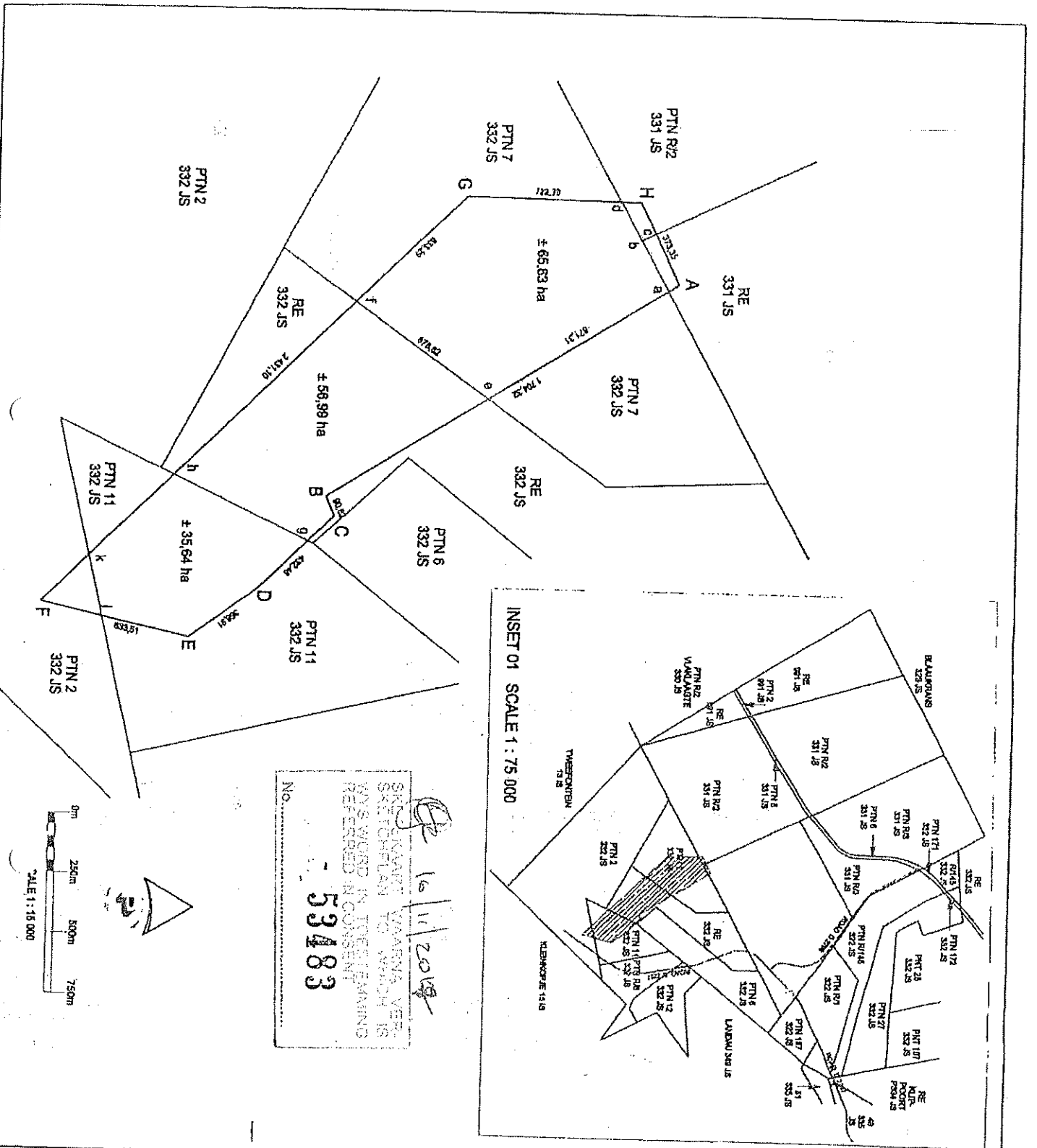

SKETCH PLAN VANINA VEEI
 SITUATED ON PARTS OF
 PORTION 2 AND REMAINDER
 OF THE FARM GROENHOUTEN 331 JS
 AND ALSO PARTS OF
 PORTION 2, PORTION 7, PORTION 11
 REMAINDER
 OF THE FARM KLIPPAN 332 JS

No. **53483**

16/11/2018

SKETCH PLAN
 PROPOSED ASH DISPOSAL DUMP
 SITUATED ON PARTS OF
 PORTION 2 AND REMAINDER
 OF THE FARM GROENHOUTEN 331 JS
 AND ALSO PARTS OF
 PORTION 2, PORTION 7, PORTION 11
 REMAINDER
 OF THE FARM KLIPPAN 332 JS

NOTES:

1. The affected farm portions are indicated on the sheet by:
 2. The figure A a b c A denotes part of Remainder of the farm Groenhouren 331 JS ± 1,38 ha in extent.
 3. The figure c d d H c denotes part of Remainder Portion 2 of the farm Groenhouren 331 JS ± 1,12 ha in extent.
 4. The figure a e f G d a denotes part of Portion 7 of the farm Klippan 332 JS ± 65,63 ha in extent.
 5. The figure a b c g h f e denotes part of Remainder of the farm Klippan 332 JS ± 56,98 ha in extent.
 6. The figure g d e l h g denotes part of Portion 11 of the farm Klippan 332 JS ± 35,64 ha in extent.
 7. The figure j f k j denotes part of Portion 2 of the farm Klippan 332 JS ± 4,03 ha in extent.
 8. The consolidated site assembly denoted by figure A B C D E F G H A measures ± 183,77 ha in extent.
- B. All dimensions and areas are approximations and subject to final survey.

REVISIONS	
NO.	DESCRIPTION



THE PRACTICE GROUP
 537 ZAKHELA ROAD, BLOEMFONTEIN, SOUTH AFRICA
 TEL: 011 462 4111
 FAX: 011 462 4112
 EMAIL: INFO@THEPRACTICEGROUP.CO.ZA

DATE DRAWN: 15/11/2018 DRAWN BY: JLD/CT/CREATED BY: JLD
 SCALE: 1:15,000 700 / 040 / 02