

	32. Department of Public Works, Roads, and Transport Balmoral Roads Camp Site Balmoral 1037
--	---

PROCLAMATION • PROKLAMASIE

PROCLAMATION 23 OF 2017

EMALAHLENI LOCAL MUNICIPALITY
NOTICE OF APPROVAL OF AMENDMENT SCHEME 2023

The Local Municipality of Emalahleni declares hereby in terms of the provisions of Section 57(1)(a) of the Town-Planning and Townships Ordinance, 1986, that it has approved an amendment scheme, being an amendment of the Emalahleni Land Use Management Scheme, 2010, by the rezoning of Portions 2, 6, 7, 11, 12, the Remaining Extent of Portion 5 and the Remaining Extent of the farm Klippan 332 JS, the Remaining Extent of Portion 2 and the Remaining Extent of the farm Groenfontein 331 JS, the Remaining Extent of Portions 1 and 145 and Portion 167 of the farm Klipfontein 322 JS from "Agricultural" to "Special" with an annexure, Annexure 781 for Industrial purposes to accommodate a Power Station and Ash Residue Disposal Facility.

Map 3 and the scheme clauses of the amendment scheme are filed with the Director, Department of Agriculture, Rural Development and Land Administration Mpumalanga Province, and the Municipal Manager, Emalahleni Local Municipality and are open for inspection at all reasonable times. This amendment is known as Emalahleni Amendment Scheme 2023 and shall come into operation on date of publication of this notice.

T JANSEN VAN VUUREN
MUNICIPAL MANAGER

Civic Centre
 Mandela Street
 eMALAHLENI
 1035

P.O. Box 3
 eMalahleni
 1035

Notice Number : 50/2017
 Publication date : Provincial Gazette of Mpumalanga: 8 September 2017

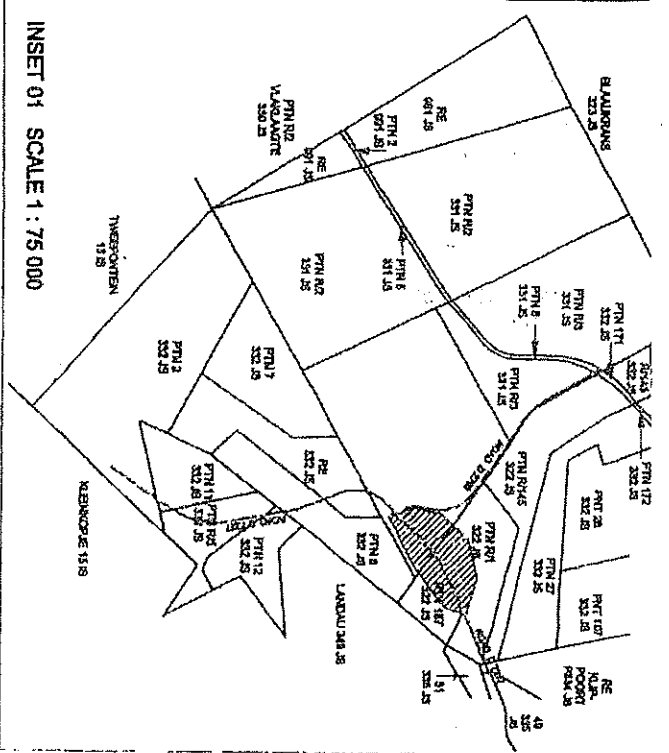

INSET 01 SCALE 1 : 75 000

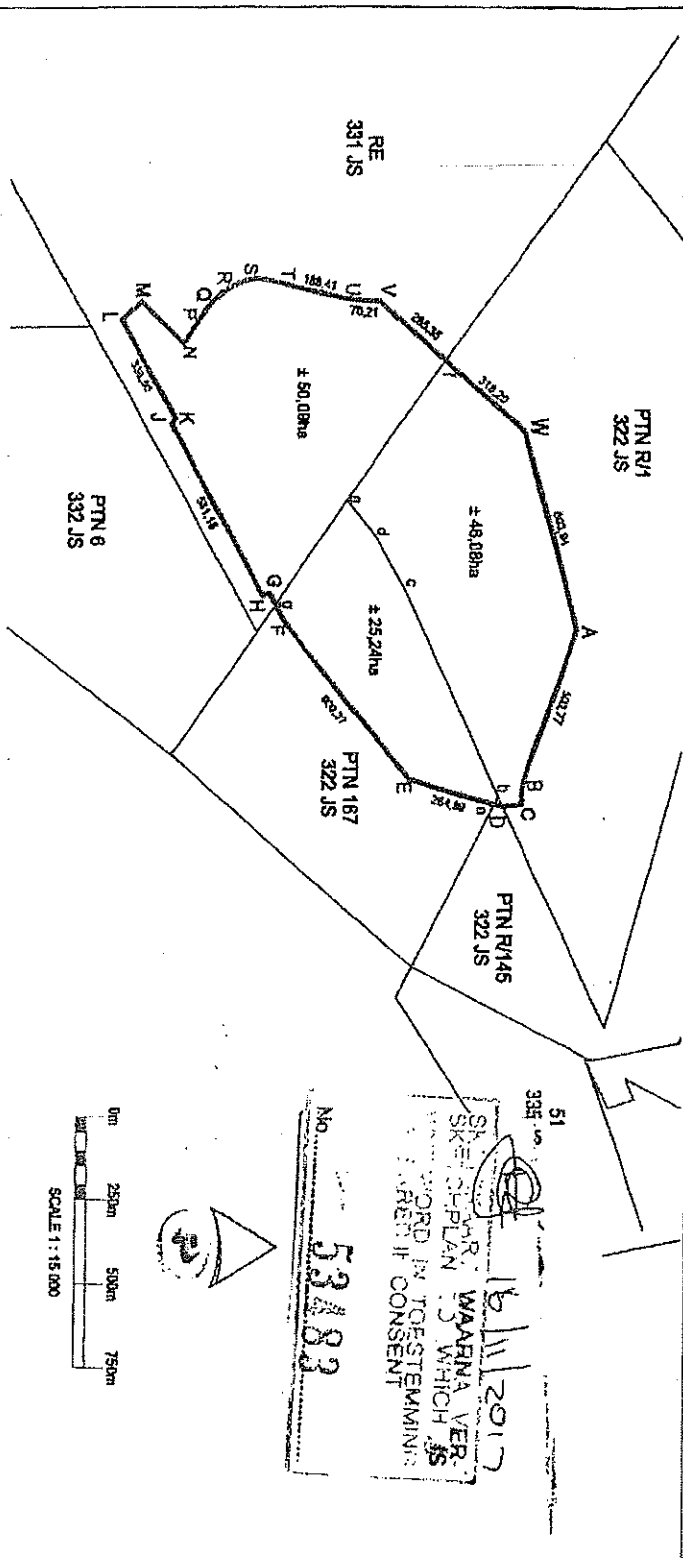

No. 53483
 16/11/2017
 SKRIPSI MAJLIS VER.
 SKRIPSI PLAN J.S. WHICH J.S.
 WORD IN TOESTEMMIN.
 IN GREN IF CONSENT

- NOTES:
- The affected farm portions are indicated on the sheet by: []
 - The figure ABCD d e f w A denotes part of Remainder Portion 1 of the farm Kibonketh 322 JS ± 48.08 ha in extent
 - The figure D e f D denotes part of Remainder Portion 145 of the farm Kibonketh 322 JS ± 4.75 ha in extent
 - The figure b a e f g e d c b denotes part of Portion 167 of the farm Kibonketh 322 JS ± 25.24 ha in extent
 - The figure g h i k l m n p q r s t u v is a portion part of Remainder of the farm Groenfontein 331 JS ± 50.09 ha in extent
 - The consultant has assembled the assembly denoted by figure ABCDEF G H J K L M N P Q R S T U V W A. Measurements ± 122.16 ha in extent.
 - All dimensions and areas are approximate and subject to final survey.

THE PRACTICE GROUP
 1 : 15 000 700 / 040 / 01

NO.	REVISIONS	DATE

CLIENT INFORMATION:
 COMPANY/INSTITUTION: []
 PROJECT/WORK ORDER NO.: []

SCALE: PLANIMETER